

# Genflex Rubber Mountings

Type Industrial and Marine Isolators

Sizes B & HD



Genflex mountings employ the well proven inclined rubber element design to achieve much higher deflections compared to simple rubber in compression devices and therefore providing superior isolation of low frequency vibration.

The pure rubber design offers excellent performance in the audible frequency range.

Natural rubber also offers inherent damping to control transient motion resulting from machine start up, run down and fault conditions.

For marine and mobile applications, a combined overload and rebound buffer is available in both the B range and HD (high deflection) variants.

Genflex Marine has Type approval by Det Norske Veritas, Korean Register of Shipping and American Bureau of Shipping.



Excellence in Anti Vibration Technology Since 1914  
[www.christiegrey.com](http://www.christiegrey.com)

## Design Features

- First grade natural rubber to metal bonded rectangular elements inclined to achieve maximum load and deflection using a combination of compression and shear loading.
- High strength SG iron castings to BS EN 1563 EN-GJS-400/15.
- Rubber elements effectively protected against oil contamination by the extended top skirt design of the top casting.
- Two different horizontal stiffness axes enable optimum system characteristics and vibration isolation to be achieved using careful orientation of the mountings.
- Marine/Mobile version available with combined overload and rebound buffer.
- A 6 mm thick ribbed rubber seating pad is available obviating the need for costly HD bolts for many industrial applications.

## Typical Applications

- Marine Propulsion Engines.
- Diesel Generating Sets.
- Engine Test Beds.
- Lift Motor Gear.
- Chillers and Cooling Towers.
- Large Fans and AHU's.
- Pumps and Compressors.
- Vibrating Screens and Hoppers.



**Christie & Grey**  
SINCE 1914

### INDUSTRIAL

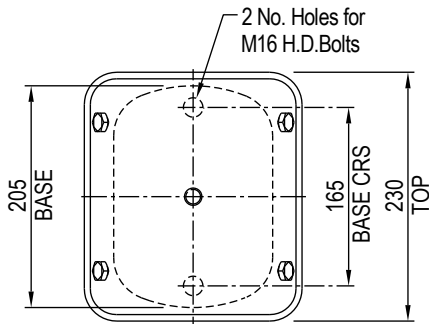
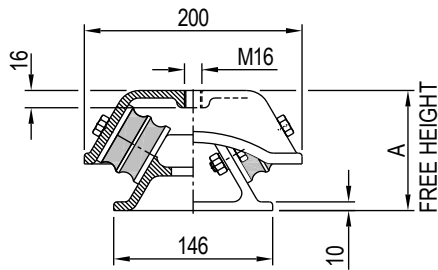

### MARINE

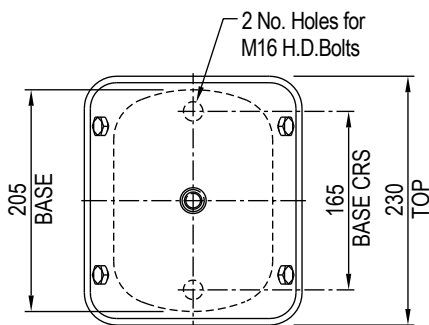
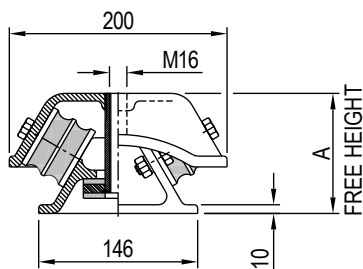

### TYPE GENFLEX INDUSTRIAL ISOLATORS SIZES B & HD

| REFERENCE  | PART No. | LOAD RANGE (kg) | STATIC STIFFNESS (kN/m) |      |     | DYNAMIC/STATIC STIFFNESS RATIO | FREE HEIGHT 'A' (mm) | WT MAX (kg) |     |
|------------|----------|-----------------|-------------------------|------|-----|--------------------------------|----------------------|-------------|-----|
|            |          |                 | kx                      | ky   | kz  |                                |                      |             |     |
| INDUSTRIAL | HD       | ■ 10.101.35     | up to 425               | 610  | 125 | 330                            | 1.14                 | 124         | 9.2 |
|            |          | 10.101.45       | up to 630               | 890  | 205 | 450                            | 1.18                 |             |     |
|            |          | 10.101.55       | up to 990               | 1280 | 268 | 680                            | 1.25                 |             |     |
|            |          | 10.101.60       | up to 1280              | 1820 | 400 | 860                            | 1.35                 |             |     |
|            |          | 10.101.70       | up to 1650              | 2360 | 480 | 1300                           | 1.70                 |             |     |
|            |          | ■ 10.101.75     | up to 2000              | 3420 | 750 | 1800                           | 1.90                 |             |     |
| INDUSTRIAL | B        | 10.102.45       | up to 560               | 2450 | 275 | 918                            | 1.18                 | 111         | 9.2 |
|            |          | 10.102.55       | up to 900               | 3630 | 360 | 1400                           | 1.25                 |             |     |
|            |          | 10.102.60       | up to 1100              | 4660 | 460 | 1850                           | 1.35                 |             |     |
|            |          | 10.102.70       | up to 1650              | 6370 | 600 | 2550                           | 1.70                 |             |     |

#### Stiffness

Static stiffness values should be used to calculate working deflection and therefore operating height.

For system natural frequency calculations, dynamic stiffness values must be used.

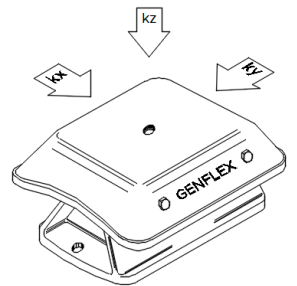

### TYPE GENFLEX MARINE ISOLATORS SIZES B & HD

| REFERENCE | PART No. | LOAD RANGE (kg) | STATIC STIFFNESS (kN/m) |      |     | DYNAMIC/STATIC STIFFNESS RATIO | FREE HEIGHT 'A' (mm) | WT (kg) MAX |     |
|-----------|----------|-----------------|-------------------------|------|-----|--------------------------------|----------------------|-------------|-----|
|           |          |                 | kx                      | ky   | kz  |                                |                      |             |     |
| MARINE    | HD       | ■ 10.103.35     | 250 - 425               | 610  | 125 | 330                            | 1.14                 | 117         | 9.5 |
|           |          | 10.103.45       | 350 - 630               | 890  | 205 | 450                            | 1.18                 |             |     |
|           |          | 10.103.55       | 550 - 990               | 1280 | 268 | 680                            | 1.25                 |             |     |
|           |          | 10.103.60       | 725 - 1280              | 1820 | 400 | 860                            | 1.35                 |             |     |
|           |          | 10.103.70       | 925 - 1650              | 2360 | 480 | 1300                           | 1.70                 |             |     |
|           |          | ■ 10.103.75     | 1150 - 2000             | 3420 | 750 | 1800                           | 1.90                 |             |     |
| MARINE    | B        | 10.104.45       | 200 - 560               | 2450 | 275 | 918                            | 1.18                 | 111         | 9.5 |
|           |          | 10.104.55       | 300 - 900               | 3630 | 360 | 1400                           | 1.25                 |             |     |
|           |          | 10.104.60       | 375 - 1100              | 4660 | 460 | 1850                           | 1.35                 |             |     |
|           |          | 10.104.70       | 550 - 1650              | 6370 | 600 | 2550                           | 1.70                 |             |     |

#### Important Notes

For **MARINE** versions the upper fixing bolt (not supplied) **MUST** locate to at least 50 mm and not more than 85 mm thread depth.

- 35 & 75 compound rubber elements are non stock items and therefore to special order only.

#### Friction Seating Pads

For freestanding applications and installation on uneven surfaces, please specify **PT No. 4137** when ordering. Seating pad 6 mm thick.

**For full instructions please refer to our datasheets DS010**

**For MARINE PROPULSION ENGINES special instructions will normally be supplied for individual applications.**

**For more detailed information and technical assistance please contact our Technical Department.**

In the interests of continual development, the Company reserve the right to make modifications to these details without notice.



#### Christie & Grey Ltd

Morley Road,  
Tonbridge, Kent  
TN9 1RA, England

T: +44 (0)1732 371100  
E: sales@christiegrey.com  
W: www.christiegrey.com



**Christie & Grey**  
SINCE 1914